

SILVERTHIN SD047CP0**4.75 in Open Type C Thin Section Bearing****Specifications**

Bore (B)	4.750 in
Outside Diameter (D)	5.750 in
Width	1/2"
Land Diameter (L ₁)	5.120 in
Land Diameter (L ₂)	5.380 in
Approximate Weight	0.94 lbs
Separator	Brass; snapover separator
Precision Class	ABEC Class 1
Bearing Type	Radial Contact (Type C)
Seals, Shields	None (Open)
Unit System	Inch

Load Capacities

Static Radial Load	3,531 lbf
Dynamic Radial Load	1,890 lbf

Interchange

Silverthin	SD047CP0	Kaydon	KD047CP0	Kaydon	KD047CP0	INA	CSCD047
SKF	FPCD412	FAG	L10TA412	NSK	NBC12012	NTN	KRD047
SSB	RD047CP0	RBC	KD047CP0*RBC				

Brass; snapover separator

1/4" balls

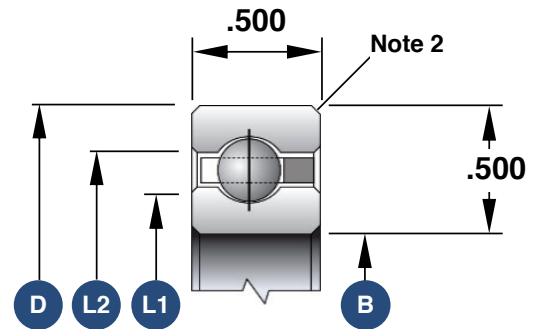

1. Load capacities are not additive
2. The maximum shaft or housing fillet radius that the bearing corners will clear for this series is 0.060"
3. Race Width Tolerance: +0.000 -0.005"

Also Available

Open Angular Contact	SD047AR0
Open 4-Point Contact	SD047XP0
Open Duplexed (Back-to-Back)	SD047BR0
Open Duplexed (Face-to-Face)	SD047FR0