

SILVERTHIN SD050AR0**5 in Open Type A Thin Section Bearing****Specifications**

Bore (B)	5.000 in
Outside Diameter (D)	6.000 in
Width	1/2"
Land Diameter (L ₁)	5.370 in
Land Diameter (L ₂)	5.630 in
Land Diameter (L ₃)	5.740 in
Approximate Weight	1.00 lbs
Separator	Brass; one piece pocket separator
Precision Class	ABEC Class 1
Bearing Type	Angular Contact (Type A)
Seals, Shields	None (Open)
Unit System	Inch

Load Capacities

Static Radial Load	4,340 lbf
Dynamic Radial Load	2,040 lbf
Static Thrust Load	12,540 lbf
Dynamic Thrust Load	4,870 lbf

Interchange

Silverthin	SD050AR0	Kaydon	KD050AR0
SKF	FPAD500	FAG	L15TA500
SSB	RD050AR0	RBC	KD050AR0*RBC

Brass; one piece pocket separator

1/4" balls

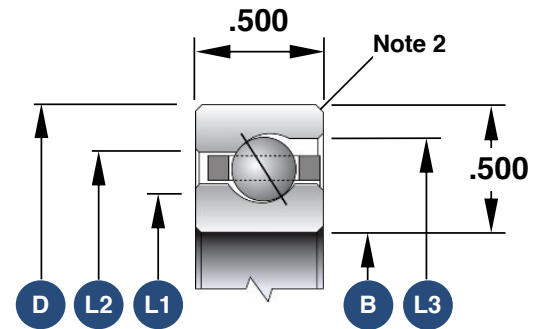

1. Load capacities are not additive
2. The maximum shaft or housing fillet radius that the bearing corners will clear for this series is 0.060"
3. Race Width Tolerance: +0.000 -0.005"

Also Available

Open Radial Contact	SD050CP0
Open 4-Point Contact	SD050XP0
Open Duplexed (Back-to-Back)	SD050BR0
Open Duplexed (Face-to-Face)	SD050FR0