

SILVERTHIN SD050CP0**5 in Open Type C Thin Section Bearing****Specifications**

Bore (B)	5.000 in
Outside Diameter (D)	6.000 in
Width	1/2"
Land Diameter (L ₁)	5.370 in
Land Diameter (L ₂)	5.630 in
Approximate Weight	1.00 lbs
Separator	Brass; snapover separator
Precision Class	ABEC Class 1
Bearing Type	Radial Contact (Type C)
Seals, Shields	None (Open)
Unit System	Inch

Load Capacities

Static Radial Load	3,760 lbf
Dynamic Radial Load	1,965 lbf

Interchange

Silverthin	SD050CP0	Kaydon	KD050CP0	Kaydon	KD050CP0	INA	CSCD050
SKF	FPCD500	FAG	L10TA500	NSK	NBC12712	NTN	KRD050
SSB	RD050CP0	RBC	KD050CP0*RBC				

Brass; snapover separator

1/4" balls

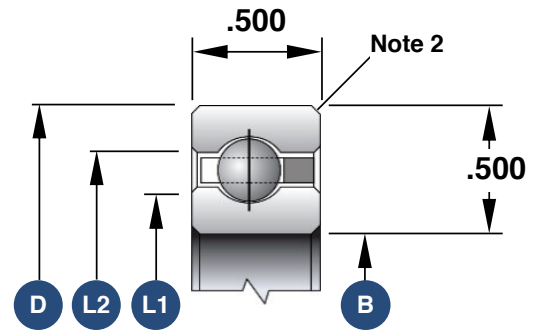

1. Load capacities are not additive
2. The maximum shaft or housing fillet radius that the bearing corners will clear for this series is 0.060"
3. Race Width Tolerance: +0.000 -0.005"

Also Available

Open Angular Contact	SD050AR0
Open 4-Point Contact	SD050XP0
Open Duplexed (Back-to-Back)	SD050BR0
Open Duplexed (Face-to-Face)	SD050FR0