

SILVERTHIN SD050XP0**5 in Open Type X Thin Section Bearing****Specifications**

Bore (B)	5.000 in
Outside Diameter (D)	6.000 in
Width	1/2"
Land Diameter (L ₁)	5.370 in
Land Diameter (L ₂)	5.630 in
Approximate Weight	1.00 lbs
Separator	Brass; snapover separator
Precision Class	ABEC Class 1
Bearing Type	4-Point Contact (Type X)
Seals, Shields	None (Open)
Unit System	Inch

Load Capacities

Static Radial Load	3,760 lbf
Dynamic Radial Load	2,590 lbf
Static Thrust Load	9,410 lbf
Dynamic Thrust Load	4,020 lbf
Static Moment Load	10,350 in-lbs
Dynamic Moment Load	5,350 in-lbs

Interchange

Silverthin	SD050XP0	Kaydon	KD050XP0	Kaydon	KD050XP0	INA	CSXD050
SKF	FPXD500	FAG	L18TA500	NSK	NBX12712	NTN	KXD050
SSB	RD050XP0	RBC	KD050XP0*RBC				

Brass; snapover separator

1/4" balls

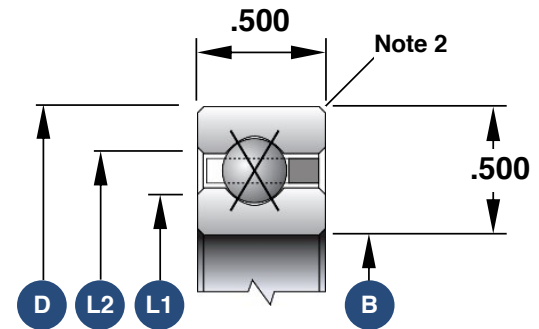

1. Load capacities are not additive
2. The maximum shaft or housing fillet radius that the bearing corners will clear for this series is 0.060"
3. Race Width Tolerance: +0.000 -0.005"

Also Available

Open Angular Contact	SD050ARO
Open Radial Contact	SD050CPO
Open Duplexed (Back-to-Back)	SD050BRO
Open Duplexed (Face-to-Face)	SD050FRO