

SILVERTHIN SD055CP0**5.5 in Open Type C Thin Section Bearing****Specifications**

Bore (B)	5.500 in
Outside Diameter (D)	6.500 in
Width	1/2"
Land Diameter (L ₁)	5.870 in
Land Diameter (L ₂)	6.130 in
Approximate Weight	1.06 lbs
Separator	Brass; snapover separator
Precision Class	ABEC Class 1
Bearing Type	Radial Contact (Type C)
Seals, Shields	None (Open)
Unit System	Inch

Load Capacities

Static Radial Load	4,100 lbf
Dynamic Radial Load	2,065 lbf

Interchange

Silverthin	SD055CP0	Kaydon	KD055CP0	Kaydon	KD055CP0	INA	CSCD055
SKF	FPCD508	FAG	L10TA508	NSK	NBC13912	NTN	KRD055
SSB	RD055CP0	RBC	KD055CP0*RBC				

Brass; snapover separator

1/4" balls

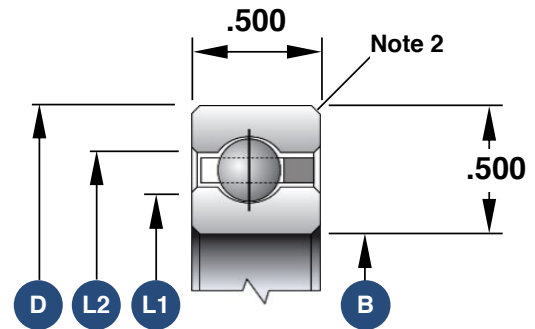

1. Load capacities are not additive
2. The maximum shaft or housing fillet radius that the bearing corners will clear for this series is 0.060"
3. Race Width Tolerance: +0.000 -0.005"

Also Available

Open Angular Contact	SD055AR0
Open 4-Point Contact	SD055XP0
Open Duplexed (Back-to-Back)	SD055BR0
Open Duplexed (Face-to-Face)	SD055FR0