

SILVERTHIN SD055XPO**5.5 in Open Type X Thin Section Bearing****Specifications**

| | |
|---------------------------------|---------------------------|
| Bore (B) | 5.500 in |
| Outside Diameter (D) | 6.500 in |
| Width | 1/2" |
| Land Diameter (L ₁) | 5.870 in |
| Land Diameter (L ₂) | 6.130 in |
| Approximate Weight | 1.06 lbs |
| Separator | Brass; snapover separator |
| Precision Class | ABEC Class 1 |
| Bearing Type | 4-Point Contact (Type X) |
| Seals, Shields | None (Open) |
| Unit System | Inch |

Load Capacities

| | |
|---------------------|---------------|
| Static Radial Load | 4,100 lbf |
| Dynamic Radial Load | 2,725 lbf |
| Static Thrust Load | 10,260 lbf |
| Dynamic Thrust Load | 4,260 lbf |
| Static Moment Load | 12,310 in-lbs |
| Dynamic Moment Load | 6,135 in-lbs |

Interchange

| | | | | | | | |
|------------|--------------------------|--------|------------------------------|--------|--------------------------|-----|-------------------------|
| Silverthin | SD055XPO | Kaydon | KD055XPO | Kaydon | KD055XPO | INA | CSXD055 |
| SKF | FPXD508 | FAG | L18TA508 | NSK | NBX13912 | NTN | KXD055 |
| SSB | RD055XPO | RBC | KD055XPO*RBC | | | | |

Brass; snapover separator

1/4" balls

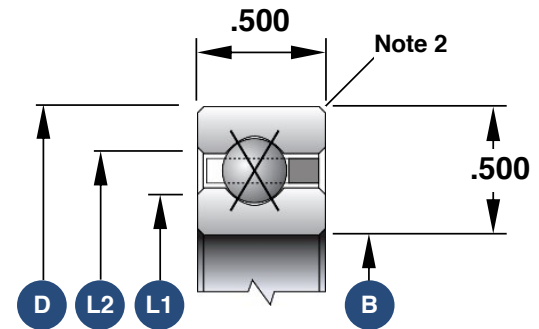

1. Load capacities are not additive
2. The maximum shaft or housing fillet radius that the bearing corners will clear for this series is 0.060"
3. Race Width Tolerance: +0.000 -0.005"

Also Available

| | |
|------------------------------|--------------------------|
| Open Angular Contact | SD055AR0 |
| Open Radial Contact | SD055CP0 |
| Open Duplexed (Back-to-Back) | SD055BR0 |
| Open Duplexed (Face-to-Face) | SD055FR0 |