

Specifications

Bore (B)	6.000 in
Outside Diameter (D)	7.000 in
Width	1/2"
Land Diameter (L ₁)	6.370 in
Land Diameter (L ₂)	6.630 in
Land Diameter (L ₃)	6.738 in
Approximate Weight	1.16 lbs
Separator	Brass; one piece pocket separator
Precision Class	ABEC Class 1
Bearing Type	Angular Contact (Type A)
Seals, Shields	None (Open)
Unit System	Inch

Load Capacities

Static Radial Load	5,130 lbf
Dynamic Radial Load	2,245 lbf
Static Thrust Load	14,820 lbf
Dynamic Thrust Load	5,440 lbf

Interchange

Silverthin	SD060AR0	Kaydon	KD060AR0	Kaydon	KD060AR0	INA	CSAD060
SKF	FPAD600	FAG	L15TA600	NSK	NBA15212	NTN	KYD060
SSB	RD060AR0	RBC	KD060AR0*RBC				

Brass; one piece pocket separator
1/4" balls

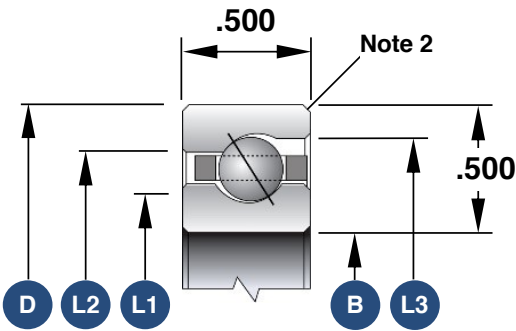

- 1. Load capacities are not additive
- 2. The maximum shaft or housing fillet radius that the bearing corners will clear for this series is 0.060"
- 3. Race Width Tolerance: +0.000 -0.005"

Also Available

Open Radial Contact	SD060CP0
Open 4-Point Contact	SD060XP0
Open Duplexed (Back-to-Back)	SD060BR0
Open Duplexed (Face-to-Face)	SD060FR0