

SILVERTHIN SD060XPO**6 in Open Type X Thin Section Bearing****Specifications**

Bore (B)	6.000 in
Outside Diameter (D)	7.000 in
Width	1/2"
Land Diameter (L ₁)	6.370 in
Land Diameter (L ₂)	6.630 in
Approximate Weight	1.16 lbs
Separator	Brass; snapover separator
Precision Class	ABEC Class 1
Bearing Type	4-Point Contact (Type X)
Seals, Shields	None (Open)
Unit System	Inch

Load Capacities

Static Radial Load	4,450 lbf
Dynamic Radial Load	2,855 lbf
Static Thrust Load	11,120 lbf
Dynamic Thrust Load	4,490 lbf
Static Moment Load	14,450 in-lbs
Dynamic Moment Load	6,960 in-lbs

Interchange

Silverthin	SD060XPO	Kaydon	KD060XPO	Kaydon	KD060XPO	INA	CSXD060
SKF	FPXD600	FAG	L18TA600	NSK	NBX15212	NTN	KXD060
SSB	RD060XPO	RBC	KD060XPO*RBC				

Brass; snapover separator

1/4" balls

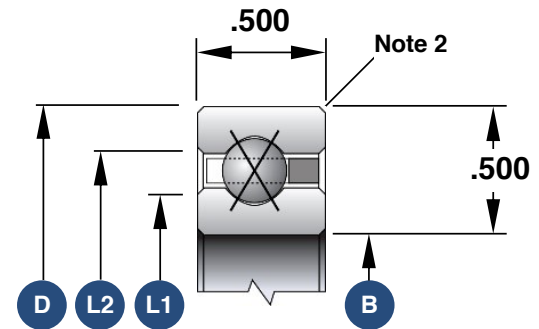

1. Load capacities are not additive
2. The maximum shaft or housing fillet radius that the bearing corners will clear for this series is 0.060"
3. Race Width Tolerance: +0.000 -0.005"

Also Available

Open Angular Contact	SD060ARO
Open Radial Contact	SD060CPO
Open Duplexed (Back-to-Back)	SD060BRO
Open Duplexed (Face-to-Face)	SD060FRO