

SILVERTHIN SD065ARO**6.5 in Open Type A Thin Section Bearing****Specifications**

Bore (B)	6.500 in
Outside Diameter (D)	7.500 in
Width	1/2"
Land Diameter (L ₁)	6.870 in
Land Diameter (L ₂)	7.130 in
Land Diameter (L ₃)	7.236 in
Approximate Weight	1.22 lbs
Separator	Brass; one piece pocket separator
Precision Class	ABEC Class 1
Bearing Type	Angular Contact (Type A)
Seals, Shields	None (Open)
Unit System	Inch

Load Capacities

Static Radial Load	5,530 lbf
Dynamic Radial Load	2,345 lbf
Static Thrust Load	15,960 lbf
Dynamic Thrust Load	5,720 lbf

Interchange

Silverthin	SD065ARO	Kaydon	KD065ARO
SKF	FPAD608	FAG	L15TA608
SSB	RD065ARO	RBC	KD065ARO*RBC

Brass; one piece pocket separator

1/4" balls

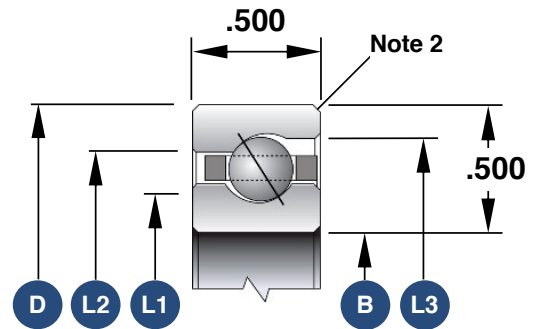

1. Load capacities are not additive
2. The maximum shaft or housing fillet radius that the bearing corners will clear for this series is 0.060"
3. Race Width Tolerance: +0.000 -0.005"

Also Available

Open Radial Contact	SD065CP0
Open 4-Point Contact	SD065XP0
Open Duplexed (Back-to-Back)	SD065BR0
Open Duplexed (Face-to-Face)	SD065FR0