

**SILVERTHIN SD065CP0****6.5 in Open Type C Thin Section Bearing****Specifications**

Bore (B)	6.500 in
Outside Diameter (D)	7.500 in
Width	1/2"
Land Diameter (L <sub>1</sub> )	6.870 in
Land Diameter (L <sub>2</sub> )	7.130 in
Approximate Weight	1.22 lbs
Separator	Brass; snapover separator
Precision Class	ABEC Class 1
Bearing Type	Radial Contact (Type C)
Seals, Shields	None (Open)
Unit System	Inch

**Load Capacities**

Static Radial Load	4,790 lbf
Dynamic Radial Load	2,255 lbf

**Interchange**

Silverthin	<a href="#">SD065CP0</a>	Kaydon	<a href="#">KD065CP0</a>	Kaydon	<a href="#">KD065CP0</a>	INA	<a href="#">CSCD065</a>
SKF	<a href="#">FPCD608</a>	FAG	<a href="#">L10TA608</a>	NSK	<a href="#">NBC16512</a>	NTN	<a href="#">KRD065</a>
SSB	<a href="#">RD065CP0</a>	RBC	<a href="#">KD065CP0*RBC</a>				

**Brass; snapover separator**

1/4" balls

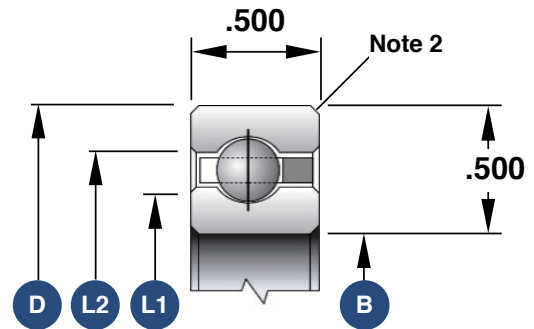

1. Load capacities are not additive
2. The maximum shaft or housing fillet radius that the bearing corners will clear for this series is 0.060"
3. Race Width Tolerance: +0.000 -0.005"

**Also Available**

Open Angular Contact	<a href="#">SD065AR0</a>
Open 4-Point Contact	<a href="#">SD065XP0</a>
Open Duplexed (Back-to-Back)	<a href="#">SD065BR0</a>
Open Duplexed (Face-to-Face)	<a href="#">SD065FR0</a>