

SILVERTHIN SD065XPO**6.5 in Open Type X Thin Section Bearing****Specifications**

Bore (B)	6.500 in
Outside Diameter (D)	7.500 in
Width	1/2"
Land Diameter (L ₁)	6.870 in
Land Diameter (L ₂)	7.130 in
Approximate Weight	1.22 lbs
Separator	Brass; snapover separator
Precision Class	ABEC Class 1
Bearing Type	4-Point Contact (Type X)
Seals, Shields	None (Open)
Unit System	Inch

Load Capacities

Static Radial Load	4,790 lbf
Dynamic Radial Load	2,980 lbf
Static Thrust Load	11,970 lbf
Dynamic Thrust Load	4,720 lbf
Static Moment Load	16,760 in-lbs
Dynamic Moment Load	7,825 in-lbs

Interchange

Silverthin	SD065XPO	Kaydon	KD065XPO	Kaydon	KD065XPO	INA	CSXD065
SKF	FPXD608	FAG	L18TA608	NSK	NBX16512	NTN	KXD065
SSB	RD065XPO	RBC	KD065XPO*RBC				

Brass; snapover separator

1/4" balls

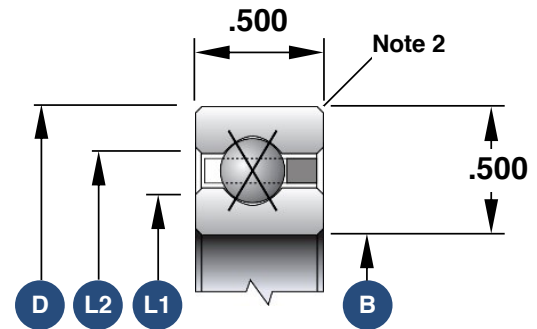

1. Load capacities are not additive
2. The maximum shaft or housing fillet radius that the bearing corners will clear for this series is 0.060"
3. Race Width Tolerance: +0.000 -0.005"

Also Available

Open Angular Contact	SD065AR0
Open Radial Contact	SD065CP0
Open Duplexed (Back-to-Back)	SD065BR0
Open Duplexed (Face-to-Face)	SD065FR0