

SILVERTHIN SD070AR0**7 in Open Type A Thin Section Bearing****Specifications**

Bore (B)	7.000 in
Outside Diameter (D)	8.000 in
Width	1/2"
Land Diameter (L ₁)	7.370 in
Land Diameter (L ₂)	7.630 in
Land Diameter (L ₃)	7.736 in
Approximate Weight	1.31 lbs
Separator	Brass; one piece pocket separator
Precision Class	ABEC Class 1
Bearing Type	Angular Contact (Type A)
Seals, Shields	None (Open)
Unit System	Inch

Load Capacities

Static Radial Load	5,920 lbf
Dynamic Radial Load	2,440 lbf
Static Thrust Load	17,100 lbf
Dynamic Thrust Load	5,990 lbf

Interchange

Silverthin	SD070AR0	Kaydon	KD070AR0
SKF	FPAD700	FAG	L15TA700
SSB	RD070AR0	RBC	KD070AR0*RBC

Brass; one piece pocket separator

1/4" balls

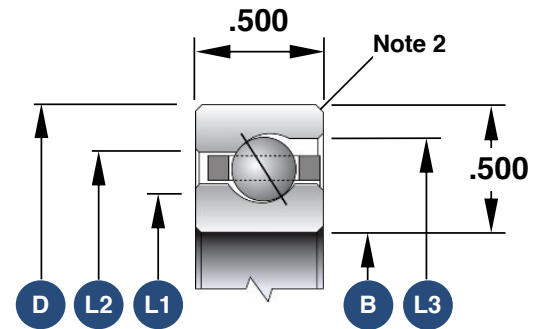

1. Load capacities are not additive
2. The maximum shaft or housing fillet radius that the bearing corners will clear for this series is 0.060"
3. Race Width Tolerance: +0.000 -0.005"

Also Available

Open Radial Contact	SD070CP0
Open 4-Point Contact	SD070XP0
Open Duplexed (Back-to-Back)	SD070BR0
Open Duplexed (Face-to-Face)	SD070FR0