

SILVERTHIN SD070XP0**7 in Open Type X Thin Section Bearing****Specifications**

Bore (B)	7.000 in
Outside Diameter (D)	8.000 in
Width	1/2"
Land Diameter (L ₁)	7.370 in
Land Diameter (L ₂)	7.630 in
Approximate Weight	1.31 lbs
Separator	Brass; snapover separator
Precision Class	ABEC Class 1
Bearing Type	4-Point Contact (Type X)
Seals, Shields	None (Open)
Unit System	Inch

Load Capacities

Static Radial Load	5,130 lbf
Dynamic Radial Load	3,105 lbf
Static Thrust Load	12,830 lbf
Dynamic Thrust Load	4,940 lbf
Static Moment Load	19,240 in-lbs
Dynamic Moment Load	8,730 in-lbs

Interchange

Silverthin	SD070XP0	Kaydon	KD070XP0	Kaydon	KD070XP0	INA	CSXD070
SKF	FPXD700	FAG	L18TA700	NSK	NBX17712	NTN	KXD070
SSB	RD070XP0	RBC	KD070XP0*RBC				

Brass; snapover separator

1/4" balls

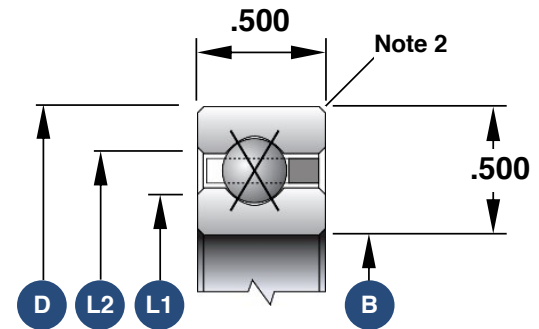

1. Load capacities are not additive
2. The maximum shaft or housing fillet radius that the bearing corners will clear for this series is 0.060"
3. Race Width Tolerance: +0.000 -0.005"

Also Available

Open Angular Contact	SD070ARO
Open Radial Contact	SD070CPO
Open Duplexed (Back-to-Back)	SD070BR0
Open Duplexed (Face-to-Face)	SD070FR0