

SILVERTHIN SD075AR0**7.5 in Open Type A Thin Section Bearing****Specifications**

Bore (B)	7.500 in
Outside Diameter (D)	8.500 in
Width	1/2"
Land Diameter (L ₁)	7.870 in
Land Diameter (L ₂)	8.130 in
Land Diameter (L ₃)	8.236 in
Approximate Weight	1.41 lbs
Separator	Brass; one piece pocket separator
Precision Class	ABEC Class 1
Bearing Type	Angular Contact (Type A)
Seals, Shields	None (Open)
Unit System	Inch

Load Capacities

Static Radial Load	6,320 lbf
Dynamic Radial Load	2,535 lbf
Static Thrust Load	18,240 lbf
Dynamic Thrust Load	6,250 lbf

Interchange

Silverthin	SD075AR0	Kaydon	KD075AR0
SKF	FPAD708	FAG	L15TA708
SSB	RD075AR0	RBC	KD075AR0*RBC

Brass; one piece pocket separator

1/4" balls

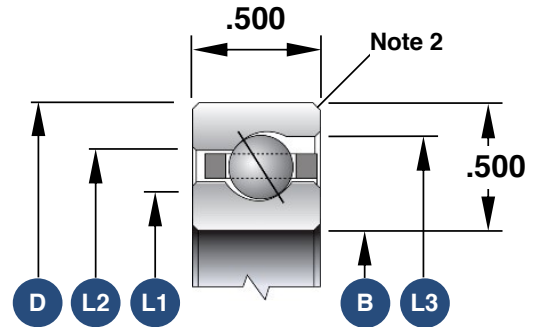

1. Load capacities are not additive
2. The maximum shaft or housing fillet radius that the bearing corners will clear for this series is 0.060"
3. Race Width Tolerance: +0.000 -0.005"

Also Available

Open Radial Contact	SD075CP0
Open 4-Point Contact	SD075XP0
Open Duplexed (Back-to-Back)	SD075BR0
Open Duplexed (Face-to-Face)	SD075FR0