

SILVERTHIN SD075CP0**7.5 in Open Type C Thin Section Bearing****Specifications**

Bore (B)	7.500 in
Outside Diameter (D)	8.500 in
Width	1/2"
Land Diameter (L ₁)	7.870 in
Land Diameter (L ₂)	8.130 in
Approximate Weight	1.41 lbs
Separator	Brass; snapover separator
Precision Class	ABEC Class 1
Bearing Type	Radial Contact (Type C)
Seals, Shields	None (Open)
Unit System	Inch

Load Capacities

Static Radial Load	5,470 lbf
Dynamic Radial Load	2,435 lbf

Interchange

Silverthin	SD075CP0	Kaydon	KD075CP0	Kaydon	KD075CP0	INA	CSCD075
SKF	FPCD708	FAG	L10TA708	NSK	NBC19012	NTN	KRD075
SSB	RD075CP0	RBC	KD075CP0*RBC				

Brass; snapover separator

1/4" balls

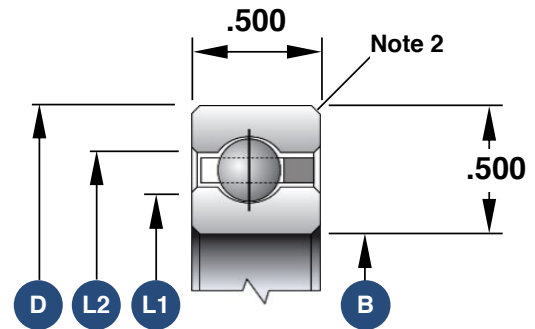

1. Load capacities are not additive
2. The maximum shaft or housing fillet radius that the bearing corners will clear for this series is 0.060"
3. Race Width Tolerance: +0.000 -0.005"

Also Available

Open Angular Contact	SD075AR0
Open 4-Point Contact	SD075XP0
Open Duplexed (Back-to-Back)	SD075BR0
Open Duplexed (Face-to-Face)	SD075FR0