

SILVERTHIN SD075XP0**7.5 in Open Type X Thin Section Bearing****Specifications**

Bore (B)	7.500 in
Outside Diameter (D)	8.500 in
Width	1/2"
Land Diameter (L ₁)	7.870 in
Land Diameter (L ₂)	8.130 in
Approximate Weight	1.41 lbs
Separator	Brass; snapover separator
Precision Class	ABEC Class 1
Bearing Type	4-Point Contact (Type X)
Seals, Shields	None (Open)
Unit System	Inch

Load Capacities

Static Radial Load	5,470 lbf
Dynamic Radial Load	3,220 lbf
Static Thrust Load	13,680 lbf
Dynamic Thrust Load	5,160 lbf
Static Moment Load	21,890 in-lbs
Dynamic Moment Load	9,670 in-lbs

Interchange

Silverthin	SD075XP0	Kaydon	KD075XP0	Kaydon	KD075XP0	INA	CSXD075
SKF	FPXD708	FAG	L18TA708	NSK	NBX19012	NTN	KXD075
SSB	RD075XP0	RBC	KD075XP0*RBC				

Brass; snapover separator

1/4" balls

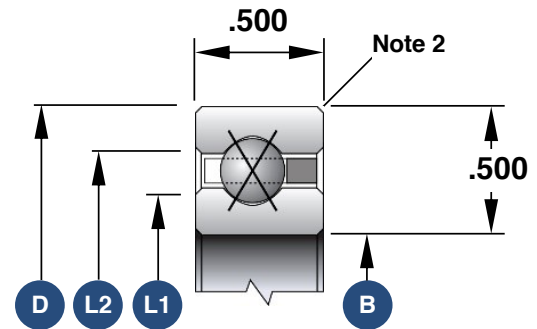

1. Load capacities are not additive
2. The maximum shaft or housing fillet radius that the bearing corners will clear for this series is 0.060"
3. Race Width Tolerance: +0.000 -0.005"

Also Available

Open Angular Contact	SD075AR0
Open Radial Contact	SD075CP0
Open Duplexed (Back-to-Back)	SD075BR0
Open Duplexed (Face-to-Face)	SD075FR0