

SILVERTHIN SD080AR0**8 in Open Type A Thin Section Bearing****Specifications**

Bore (B)	8.000 in
Outside Diameter (D)	9.000 in
Width	1/2"
Land Diameter (L ₁)	8.370 in
Land Diameter (L ₂)	8.630 in
Land Diameter (L ₃)	8.734 in
Approximate Weight	1.53 lbs
Separator	Brass; one piece pocket separator
Precision Class	ABEC Class 1
Bearing Type	Angular Contact (Type A)
Seals, Shields	None (Open)
Unit System	Inch

Load Capacities

Static Radial Load	6,710 lbf
Dynamic Radial Load	2,625 lbf
Static Thrust Load	19,380 lbf
Dynamic Thrust Load	6,510 lbf

Interchange

Silverthin	SD080AR0	Kaydon	KD080AR0
SKF	FPAD800	FAG	L15TA800
SSB	RD080AR0	RBC	KD080AR0*RBC

Brass; one piece pocket separator

1/4" balls

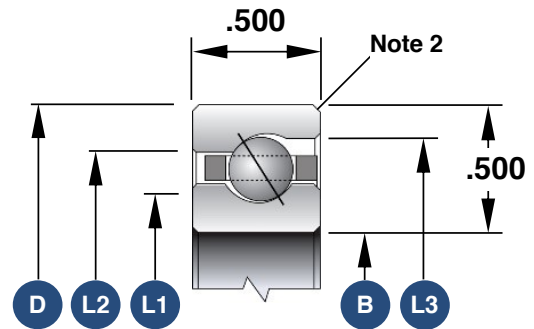

1. Load capacities are not additive
2. The maximum shaft or housing fillet radius that the bearing corners will clear for this series is 0.060"
3. Race Width Tolerance: +0.000 -0.005"

Also Available

Open Radial Contact	SD080CP0
Open 4-Point Contact	SD080XP0
Open Duplexed (Back-to-Back)	SD080BR0
Open Duplexed (Face-to-Face)	SD080FR0