

SILVERTHIN SD080XP0**8 in Open Type X Thin Section Bearing****Specifications**

Bore (B)	8.000 in
Outside Diameter (D)	9.000 in
Width	1/2"
Land Diameter (L ₁)	8.370 in
Land Diameter (L ₂)	8.630 in
Approximate Weight	1.53 lbs
Separator	Brass; snapover separator
Precision Class	ABEC Class 1
Bearing Type	4-Point Contact (Type X)
Seals, Shields	None (Open)
Unit System	Inch

Load Capacities

Static Radial Load	5,810 lbf
Dynamic Radial Load	3,340 lbf
Static Thrust Load	14,540 lbf
Dynamic Thrust Load	5,370 lbf
Static Moment Load	24,710 in-lbs
Dynamic Moment Load	10,645 in-lbs

Interchange

Silverthin	SD080XP0	Kaydon	KD080XP0	Kaydon	KD080XP0	INA	CSXD080
SKF	FPXD800	FAG	L18TA800	NSK	NBX20312	NTN	KXD080
SSB	RD080XP0	RBC	KD080XP0*RBC				

Brass; snapover separator

1/4" balls

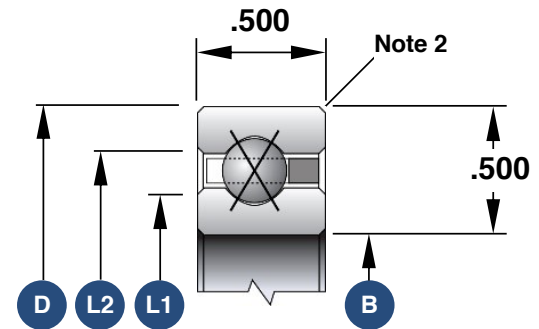

1. Load capacities are not additive
2. The maximum shaft or housing fillet radius that the bearing corners will clear for this series is 0.060"
3. Race Width Tolerance: +0.000 -0.005"

Also Available

Open Angular Contact	SD080ARO
Open Radial Contact	SD080CPO
Open Duplexed (Back-to-Back)	SD080BRO
Open Duplexed (Face-to-Face)	SD080FRO