

SILVERTHIN SD090XP0**9 in Open Type X Thin Section Bearing****Specifications**

Bore (B)	9.000 in
Outside Diameter (D)	10.000 in
Width	1/2"
Land Diameter (L ₁)	9.370 in
Land Diameter (L ₂)	9.630 in
Approximate Weight	1.72 lbs
Separator	Brass; snapover separator
Precision Class	ABEC Class 1
Bearing Type	4-Point Contact (Type X)
Seals, Shields	None (Open)
Unit System	Inch

Load Capacities

Static Radial Load	6,500 lbf
Dynamic Radial Load	3,560 lbf
Static Thrust Load	16,250 lbf
Dynamic Thrust Load	5,790 lbf
Static Moment Load	30,870 in-lbs
Dynamic Moment Load	12,695 in-lbs

Interchange

Silverthin	SD090XP0	Kaydon	KD090XP0	Kaydon	KD090XP0	INA	CSXD090
SKF	FPXD900	FAG	L18TA900	NSK	NBX22812	NTN	KXD090
SSB	RD090XP0	RBC	KD090XP0*RBC				

Brass; snapover separator

1/4" balls

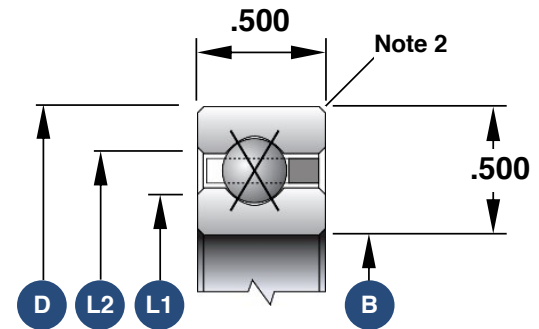

1. Load capacities are not additive
2. The maximum shaft or housing fillet radius that the bearing corners will clear for this series is 0.060"
3. Race Width Tolerance: +0.000 -0.005"

Also Available

Open Angular Contact	SD090ARO
Open Radial Contact	SD090CPO
Open Duplexed (Back-to-Back)	SD090BRO
Open Duplexed (Face-to-Face)	SD090FRO