

SILVERTHIN SD100AR0**10 in Open Type A Thin Section Bearing****Specifications**

Bore (B)	10.000 in
Outside Diameter (D)	11.000 in
Width	1/2"
Land Diameter (L ₁)	10.370 in
Land Diameter (L ₂)	10.630 in
Land Diameter (L ₃)	10.732 in
Approximate Weight	1.88 lbs
Separator	Brass; one piece pocket separator
Precision Class	ABEC Class 1
Bearing Type	Angular Contact (Type A)
Seals, Shields	None (Open)
Unit System	Inch

Load Capacities

Static Radial Load	8,290 lbf
Dynamic Radial Load	2,970 lbf
Static Thrust Load	23,940 lbf
Dynamic Thrust Load	7,500 lbf

Interchange

Silverthin	SD100AR0	Kaydon	KD100AR0
SKF	FPAD1000	FAG	L15TA1000
SSB	RD100AR0	RBC	KD100AR0*RBC

Brass; one piece pocket separator

1/4" balls

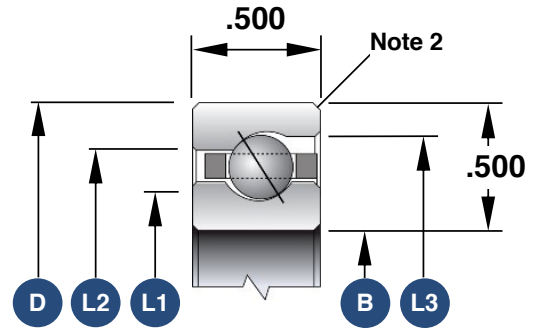

1. Load capacities are not additive
2. The maximum shaft or housing fillet radius that the bearing corners will clear for this series is 0.060"
3. Race Width Tolerance: +0.000 -0.005"

Also Available

Open Radial Contact	SD100CP0
Open 4-Point Contact	SD100XP0
Open Duplexed (Back-to-Back)	SD100BR0
Open Duplexed (Face-to-Face)	SD100FR0