

SILVERTHIN SD100XPO**10 in Open Type X Thin Section Bearing****Specifications**

Bore (B)	10.000 in
Outside Diameter (D)	11.000 in
Width	1/2"
Land Diameter (L ₁)	10.370 in
Land Diameter (L ₂)	10.630 in
Approximate Weight	1.88 lbs
Separator	Brass; snapover separator
Precision Class	ABEC Class 1
Bearing Type	4-Point Contact (Type X)
Seals, Shields	None (Open)
Unit System	Inch

Load Capacities

Static Radial Load	7,180 lbf
Dynamic Radial Load	3,775 lbf
Static Thrust Load	17,960 lbf
Dynamic Thrust Load	6,190 lbf
Static Moment Load	37,710 in-lbs
Dynamic Moment Load	14,870 in-lbs

Interchange

Silverthin	SD100XPO	Kaydon	KD100XPO	Kaydon	KD100XPO	INA	CSXD100
SKF	FPXD1000	FAG	L18TA1000	NSK	NBX25412	NTN	KXD100
SSB	RD100XPO	RBC	KD100XPO*RBC				

Brass; snapover separator

1/4" balls

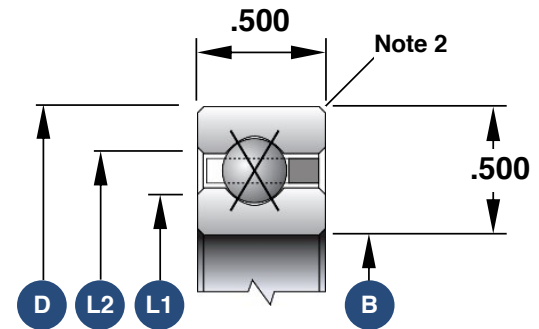

1. Load capacities are not additive
2. The maximum shaft or housing fillet radius that the bearing corners will clear for this series is 0.060"
3. Race Width Tolerance: +0.000 -0.005"

Also Available

Open Angular Contact	SD100ARO
Open Radial Contact	SD100CPO
Open Duplexed (Back-to-Back)	SD100BRO
Open Duplexed (Face-to-Face)	SD100FRO