

SILVERTHIN SD110AR0**11 in Open Type A Thin Section Bearing****Specifications**

Bore (B)	11.000 in
Outside Diameter (D)	12.000 in
Width	1/2"
Land Diameter (L ₁)	11.370 in
Land Diameter (L ₂)	11.630 in
Land Diameter (L ₃)	11.730 in
Approximate Weight	2.06 lbs
Separator	Brass; one piece pocket separator
Precision Class	ABEC Class 1
Bearing Type	Angular Contact (Type A)
Seals, Shields	None (Open)
Unit System	Inch

Load Capacities

Static Radial Load	9,080 lbf
Dynamic Radial Load	3,135 lbf
Static Thrust Load	26,220 lbf
Dynamic Thrust Load	7,960 lbf

Interchange

Silverthin	SD110AR0	Kaydon	KD110AR0
SKF	FPAD1100	FAG	L15TA1100
SSB	RD110AR0	RBC	KD110AR0*RBC

Brass; one piece pocket separator

1/4" balls

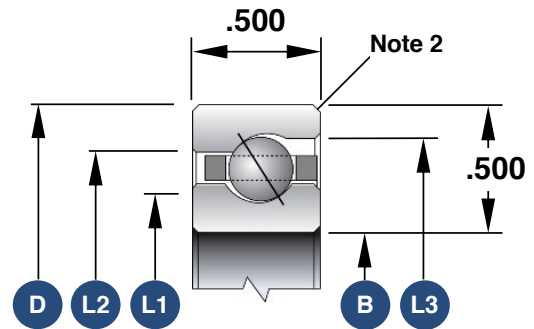

1. Load capacities are not additive
2. The maximum shaft or housing fillet radius that the bearing corners will clear for this series is 0.060"
3. Race Width Tolerance: +0.000 -0.005"

Also Available

Open Radial Contact	SD110CP0
Open 4-Point Contact	SD110XP0
Open Duplexed (Back-to-Back)	SD110BR0
Open Duplexed (Face-to-Face)	SD110FR0