

SILVERTHIN SD110CP0**11 in Open Type C Thin Section Bearing****Specifications**

| | |
|---------------------------------|---------------------------|
| Bore (B) | 11.000 in |
| Outside Diameter (D) | 12.000 in |
| Width | 1/2" |
| Land Diameter (L ₁) | 11.370 in |
| Land Diameter (L ₂) | 11.630 in |
| Approximate Weight | 2.06 lbs |
| Separator | Brass; snapover separator |
| Precision Class | ABEC Class 1 |
| Bearing Type | Radial Contact (Type C) |
| Seals, Shields | None (Open) |
| Unit System | Inch |

Load Capacities

| | |
|---------------------|-----------|
| Static Radial Load | 7,870 lbf |
| Dynamic Radial Load | 3,000 lbf |

Interchange

| | | | | | | | |
|------------|--------------------------|--------|------------------------------|--------|--------------------------|-----|-------------------------|
| Silverthin | SD110CP0 | Kaydon | KD110CP0 | Kaydon | KD110CP0 | INA | CSCD110 |
| SKF | FPCD1100 | FAG | L10TA1100 | NSK | NBC27912 | NTN | KRD110 |
| SSB | RD110CP0 | RBC | KD110CP0*RBC | | | | |

Brass; snapover separator

1/4" balls

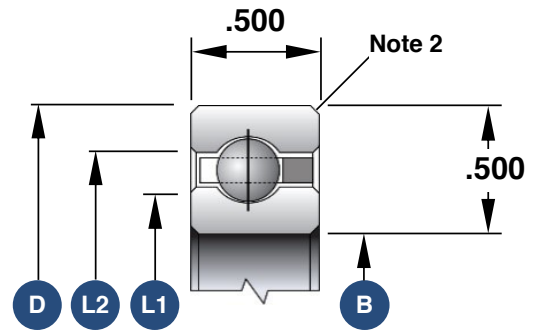

1. Load capacities are not additive
2. The maximum shaft or housing fillet radius that the bearing corners will clear for this series is 0.060"
3. Race Width Tolerance: +0.000 -0.005"

Also Available

| | |
|------------------------------|--------------------------|
| Open Angular Contact | SD110AR0 |
| Open 4-Point Contact | SD110XP0 |
| Open Duplexed (Back-to-Back) | SD110BR0 |
| Open Duplexed (Face-to-Face) | SD110FR0 |