

SILVERTHIN SD110XP0**11 in Open Type X Thin Section Bearing****Specifications**

Bore (B)	11.000 in
Outside Diameter (D)	12.000 in
Width	1/2"
Land Diameter (L ₁)	11.370 in
Land Diameter (L ₂)	11.630 in
Approximate Weight	2.06 lbs
Separator	Brass; snapover separator
Precision Class	ABEC Class 1
Bearing Type	4-Point Contact (Type X)
Seals, Shields	None (Open)
Unit System	Inch

Load Capacities

Static Radial Load	7,870 lbf
Dynamic Radial Load	3,980 lbf
Static Thrust Load	19,670 lbf
Dynamic Thrust Load	6,570 lbf
Static Moment Load	45,230 in-lbs
Dynamic Moment Load	17,175 in-lbs

Interchange

Silverthin	SD110XP0	Kaydon	KD110XP0	Kaydon	KD110XP0	INA	CSXD110
SKF	FPXD1100	FAG	L18TA1100	NSK	NBX27912	NTN	KXD110
SSB	RD110XP0	RBC	KD110XP0*RBC				

Brass; snapover separator

1/4" balls

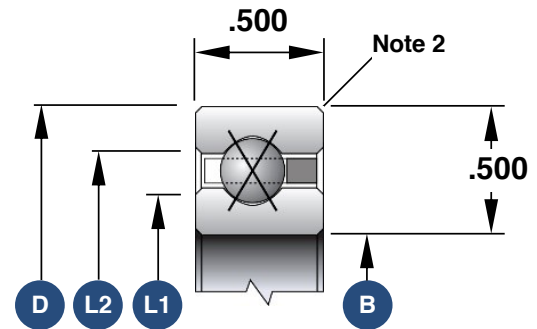

1. Load capacities are not additive
2. The maximum shaft or housing fillet radius that the bearing corners will clear for this series is 0.060"
3. Race Width Tolerance: +0.000 -0.005"

Also Available

Open Angular Contact	SD110ARO
Open Radial Contact	SD110CPO
Open Duplexed (Back-to-Back)	SD110BR0
Open Duplexed (Face-to-Face)	SD110FR0