

SILVERTHIN SD120CP0**12 in Open Type C Thin Section Bearing****Specifications**

Bore (B)	12.000 in
Outside Diameter (D)	13.000 in
Width	1/2"
Land Diameter (L ₁)	12.370 in
Land Diameter (L ₂)	12.630 in
Approximate Weight	2.25 lbs
Separator	Brass; snapover separator
Precision Class	ABEC Class 1
Bearing Type	Radial Contact (Type C)
Seals, Shields	None (Open)
Unit System	Inch

Load Capacities

Static Radial Load	8,550 lbf
Dynamic Radial Load	3,150 lbf

Interchange

Silverthin	SD120CP0	Kaydon	KD120CP0	Kaydon	KD120CP0	INA	CSCD120
SKF	FPCD1200	FAG	L10TA1200	NSK	NBC30412	NTN	KRD120
SSB	RD120CP0	RBC	KD120CP0*RBC				

Brass; snapover separator

1/4" balls

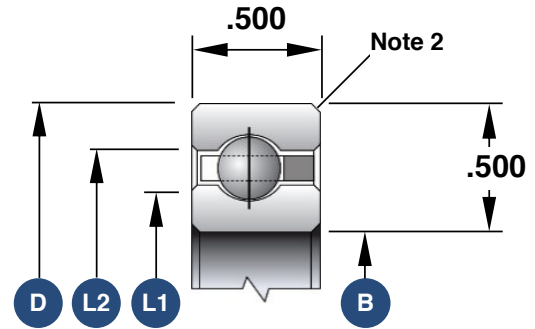

1. Load capacities are not additive
2. The maximum shaft or housing fillet radius that the bearing corners will clear for this series is 0.060"
3. Race Width Tolerance: +0.000 -0.005"

Also Available

Open Angular Contact	SD120AR0
Open 4-Point Contact	SD120XP0
Open Duplexed (Back-to-Back)	SD120BR0
Open Duplexed (Face-to-Face)	SD120FR0