

SILVERTHIN SD120XP0**12 in Open Type X Thin Section Bearing****Specifications**

Bore (B)	12.000 in
Outside Diameter (D)	13.000 in
Width	1/2"
Land Diameter (L ₁)	12.370 in
Land Diameter (L ₂)	12.630 in
Approximate Weight	2.25 lbs
Separator	Brass; snapover separator
Precision Class	ABEC Class 1
Bearing Type	4-Point Contact (Type X)
Seals, Shields	None (Open)
Unit System	Inch

Load Capacities

Static Radial Load	8,550 lbf
Dynamic Radial Load	4,180 lbf
Static Thrust Load	21,380 lbf
Dynamic Thrust Load	6,950 lbf
Static Moment Load	53,440 in-lbs
Dynamic Moment Load	19,590 in-lbs

Interchange

Silverthin	SD120XP0	Kaydon	KD120XP0	Kaydon	KD120XP0	INA	CSXD120
SKF	FPXD1200	FAG	L18TA1200	NSK	NBX30412	NTN	KXD120
SSB	RD120XP0	RBC	KD120XP0*RBC				

Brass; snapover separator

1/4" balls

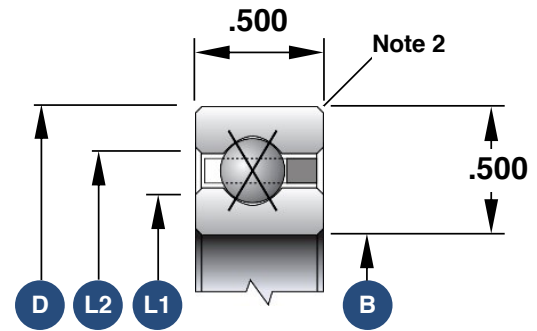

1. Load capacities are not additive
2. The maximum shaft or housing fillet radius that the bearing corners will clear for this series is 0.060"
3. Race Width Tolerance: +0.000 -0.005"

Also Available

Open Angular Contact	SD120AR0
Open Radial Contact	SD120CP0
Open Duplexed (Back-to-Back)	SD120BR0
Open Duplexed (Face-to-Face)	SD120FR0