

**SILVERTHIN SD140AR0****14 in Open Type A Thin Section Bearing****Specifications**

Bore (B)	14.000 in
Outside Diameter (D)	15.000 in
Width	1/2"
Land Diameter (L <sub>1</sub> )	14.370 in
Land Diameter (L <sub>2</sub> )	14.630 in
Land Diameter (L <sub>3</sub> )	14.724 in
Approximate Weight	2.73 lbs
Separator	Brass; one piece pocket separator
Precision Class	ABEC Class 1
Bearing Type	Angular Contact (Type A)
Seals, Shields	None (Open)
Unit System	Inch

**Load Capacities**

Static Radial Load	11,450 lbf
Dynamic Radial Load	3,580 lbf
Static Thrust Load	33,060 lbf
Dynamic Thrust Load	9,290 lbf

**Interchange**

Silverthin	<b>SD140AR0</b>	Kaydon	<b>KD140AR0</b>
SKF	<b>FPAD1400</b>	FAG	<b>L15TA1400</b>
SSB	<b>RD140AR0</b>	RBC	<b>KD140AR0*RBC</b>

**Brass; one piece pocket separator**

1/4" balls

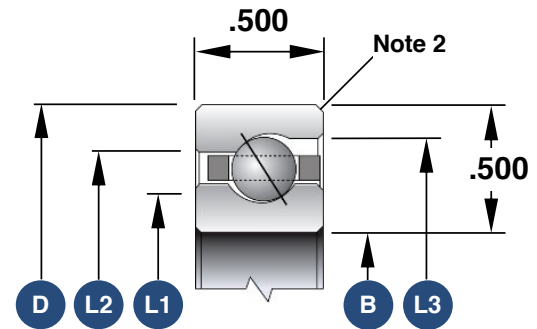

1. Load capacities are not additive
2. The maximum shaft or housing fillet radius that the bearing corners will clear for this series is 0.060"
3. Race Width Tolerance: +0.000 -0.005"

**Also Available**

Open Radial Contact	<b>SD140CP0</b>
Open 4-Point Contact	<b>SD140XP0</b>
Open Duplexed (Back-to-Back)	<b>SD140BR0</b>
Open Duplexed (Face-to-Face)	<b>SD140FR0</b>