

SILVERTHIN SD140CP0**14 in Open Type C Thin Section Bearing****Specifications**

Bore (B)	14.000 in
Outside Diameter (D)	15.000 in
Width	1/2"
Land Diameter (L ₁)	14.370 in
Land Diameter (L ₂)	14.630 in
Approximate Weight	2.73 lbs
Separator	Brass; snapover separator
Precision Class	ABEC Class 1
Bearing Type	Radial Contact (Type C)
Seals, Shields	None (Open)
Unit System	Inch

Load Capacities

Static Radial Load	9,920 lbf
Dynamic Radial Load	3,425 lbf

Interchange

Silverthin	SD140CP0	Kaydon	KD140CP0	Kaydon	KD140CP0	INA	CSCD140
SKF	FPCD1400	FAG	L10TA1400	NSK	NBC35512	NTN	KRD140
SSB	RD140CP0	RBC	KD140CP0*RBC				

Brass; snapover separator

1/4" balls

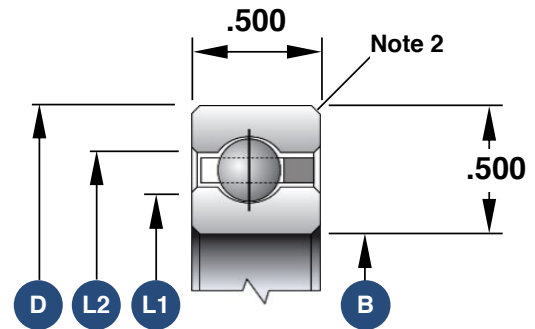

1. Load capacities are not additive
2. The maximum shaft or housing fillet radius that the bearing corners will clear for this series is 0.060"
3. Race Width Tolerance: +0.000 -0.005"

Also Available

Open Angular Contact	SD140AR0
Open 4-Point Contact	SD140XP0
Open Duplexed (Back-to-Back)	SD140BR0
Open Duplexed (Face-to-Face)	SD140FR0