

SILVERTHIN SD140XP0**14 in Open Type X Thin Section Bearing****Specifications**

Bore (B)	14.000 in
Outside Diameter (D)	15.000 in
Width	1/2"
Land Diameter (L ₁)	14.370 in
Land Diameter (L ₂)	14.630 in
Approximate Weight	2.73 lbs
Separator	Brass; snapover separator
Precision Class	ABEC Class 1
Bearing Type	4-Point Contact (Type X)
Seals, Shields	None (Open)
Unit System	Inch

Load Capacities

Static Radial Load	9,920 lbf
Dynamic Radial Load	4,550 lbf
Static Thrust Load	24,800 lbf
Dynamic Thrust Load	7,670 lbf
Static Moment Load	71,910 in-lbs
Dynamic Moment Load	24,755 in-lbs

Interchange

Silverthin	SD140XP0	Kaydon	KD140XP0	Kaydon	KD140XP0	INA	CSXD140
SKF	FPXD1400	FAG	L18TA1400	NSK	NBX35512	NTN	KXD140
SSB	RD140XP0	RBC	KD140XP0*RBC				

Brass; snapover separator

1/4" balls

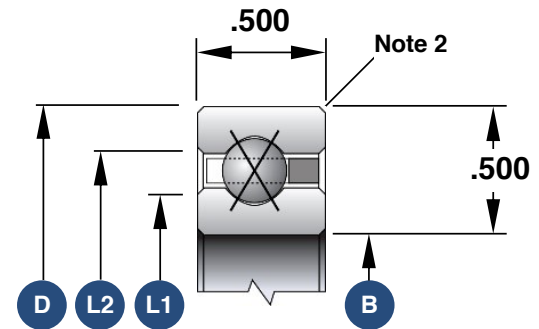

1. Load capacities are not additive
2. The maximum shaft or housing fillet radius that the bearing corners will clear for this series is 0.060"
3. Race Width Tolerance: +0.000 -0.005"

Also Available

Open Angular Contact	SD140ARO
Open Radial Contact	SD140CPO
Open Duplexed (Back-to-Back)	SD140BR0
Open Duplexed (Face-to-Face)	SD140FR0