

SILVERTHIN SD160AR0**16 in Open Type A Thin Section Bearing****Specifications**

Bore (B)	16.000 in
Outside Diameter (D)	17.000 in
Width	1/2"
Land Diameter (L ₁)	16.370 in
Land Diameter (L ₂)	16.630 in
Land Diameter (L ₃)	16.718 in
Approximate Weight	3.10 lbs
Separator	Brass; one piece pocket separator
Precision Class	ABEC Class 1
Bearing Type	Angular Contact (Type A)
Seals, Shields	None (Open)
Unit System	Inch

Load Capacities

Static Radial Load	13,030 lbf
Dynamic Radial Load	3,855 lbf
Static Thrust Load	37,620 lbf
Dynamic Thrust Load	10,130 lbf

Interchange

Silverthin	SD160AR0	Kaydon	KD160AR0
SKF	FPAD1600	FAG	L15TA1600
SSB	RD160AR0	RBC	KD160AR0*RBC

Brass; one piece pocket separator

1/4" balls

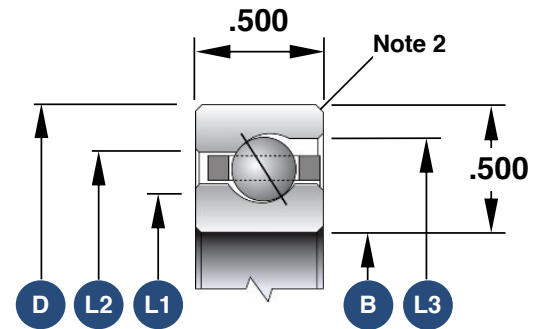

1. Load capacities are not additive
2. The maximum shaft or housing fillet radius that the bearing corners will clear for this series is 0.060"
3. Race Width Tolerance: +0.000 -0.005"

Also Available

Open Radial Contact	SD160CP0
Open 4-Point Contact	SD160XP0
Open Duplexed (Back-to-Back)	SD160BR0
Open Duplexed (Face-to-Face)	SD160FR0