

SILVERTHIN SD160XP0**16 in Open Type X Thin Section Bearing****Specifications**

Bore (B)	16.000 in
Outside Diameter (D)	17.000 in
Width	1/2"
Land Diameter (L ₁)	16.370 in
Land Diameter (L ₂)	16.630 in
Approximate Weight	3.10 lbs
Separator	Brass; snapover separator
Precision Class	ABEC Class 1
Bearing Type	4-Point Contact (Type X)
Seals, Shields	None (Open)
Unit System	Inch

Load Capacities

Static Radial Load	11,290 lbf
Dynamic Radial Load	4,900 lbf
Static Thrust Load	28,220 lbf
Dynamic Thrust Load	8,360 lbf
Static Moment Load	93,110 in-lbs
Dynamic Moment Load	30,325 in-lbs

Interchange

Silverthin	SD160XP0	Kaydon	KD160XP0	Kaydon	KD160XP0	INA	CSXD160
SKF	FPXD1600	FAG	L18TA1600	NSK	NBX40612	NTN	KXD160
SSB	RD160XP0	RBC	KD160XP0*RBC				

Brass; snapover separator

1/4" balls

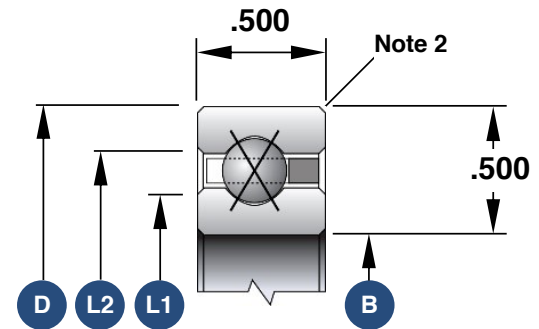

1. Load capacities are not additive
2. The maximum shaft or housing fillet radius that the bearing corners will clear for this series is 0.060"
3. Race Width Tolerance: +0.000 -0.005"

Also Available

Open Angular Contact	SD160ARO
Open Radial Contact	SD160CPO
Open Duplexed (Back-to-Back)	SD160BR0
Open Duplexed (Face-to-Face)	SD160FR0