

SILVERTHIN SD180CP0**18 in Open Type C Thin Section Bearing****Specifications**

Bore (B)	18.000 in
Outside Diameter (D)	19.000 in
Width	1/2"
Land Diameter (L ₁)	18.370 in
Land Diameter (L ₂)	18.630 in
Approximate Weight	3.48 lbs
Separator	Brass; snapover separator
Precision Class	ABEC Class 1
Bearing Type	Radial Contact (Type C)
Seals, Shields	None (Open)
Unit System	Inch

Load Capacities

Static Radial Load	12,650 lbf
Dynamic Radial Load	3,935 lbf

Interchange

Silverthin	SD180CP0	Kaydon	KD180CP0	Kaydon	KD180CP0	INA	CSCD180
SKF	FPCD1800	FAG	L10TA1800	NSK	NBC45712	NTN	KRD180
SSB	RD180CP0	RBC	KD180CP0*RBC				

Brass; snapover separator

1/4" balls

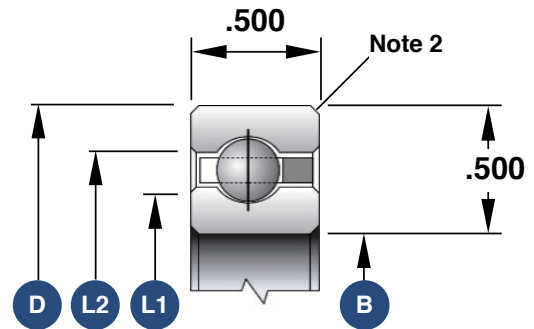

1. Load capacities are not additive
2. The maximum shaft or housing fillet radius that the bearing corners will clear for this series is 0.060"
3. Race Width Tolerance: +0.000 -0.005"

Also Available

Open Angular Contact	SD180AR0
Open 4-Point Contact	SD180XP0
Open Duplexed (Back-to-Back)	SD180BR0
Open Duplexed (Face-to-Face)	SD180FR0