

SILVERTHIN SD180XP0**18 in Open Type X Thin Section Bearing****Specifications**

Bore (B)	18.000 in
Outside Diameter (D)	19.000 in
Width	1/2"
Land Diameter (L ₁)	18.370 in
Land Diameter (L ₂)	18.630 in
Approximate Weight	3.48 lbs
Separator	Brass; snapover separator
Precision Class	ABEC Class 1
Bearing Type	4-Point Contact (Type X)
Seals, Shields	None (Open)
Unit System	Inch

Load Capacities

Static Radial Load	12,650 lbf
Dynamic Radial Load	5,225 lbf
Static Thrust Load	31,640 lbf
Dynamic Thrust Load	9,030 lbf
Static Moment Load	117,000 in-lbs
Dynamic Moment Load	36,270 in-lbs

Interchange

Silverthin	SD180XP0	Kaydon	KD180XP0	Kaydon	KD180XP0	INA	CSXD180
SKF	FPXD1800	FAG	L18TA1800	NSK	NBX45712	NTN	KXD180
SSB	RD180XP0	RBC	KD180XP0*RBC				

Brass; snapover separator

1/4" balls

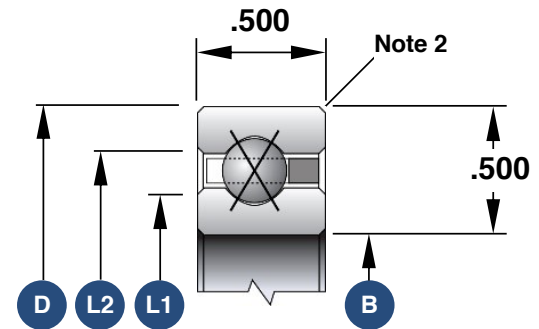

1. Load capacities are not additive
2. The maximum shaft or housing fillet radius that the bearing corners will clear for this series is 0.060"
3. Race Width Tolerance: +0.000 -0.005"

Also Available

Open Angular Contact	SD180ARO
Open Radial Contact	SD180CPO
Open Duplexed (Back-to-Back)	SD180BRO
Open Duplexed (Face-to-Face)	SD180FRO