

SILVERTHIN SD200AR0**20 in Open Type A Thin Section Bearing****Specifications**

Bore (B)	20.000 in
Outside Diameter (D)	21.000 in
Width	1/2"
Land Diameter (L ₁)	20.370 in
Land Diameter (L ₂)	20.630 in
Land Diameter (L ₃)	20.705 in
Approximate Weight	3.85 lbs
Separator	Brass; one piece pocket separator
Precision Class	ABEC Class 1
Bearing Type	Angular Contact (Type A)
Seals, Shields	None (Open)
Unit System	Inch

Load Capacities

Static Radial Load	16,190 lbf
Dynamic Radial Load	4,355 lbf
Static Thrust Load	46,740 lbf
Dynamic Thrust Load	11,710 lbf

Interchange

Silverthin	SD200AR0	Kaydon	KD200AR0
SKF	FPAD2000	FAG	L15TA2000
SSB	RD200AR0	RBC	KD200AR0*RBC

Brass; one piece pocket separator

1/4" balls

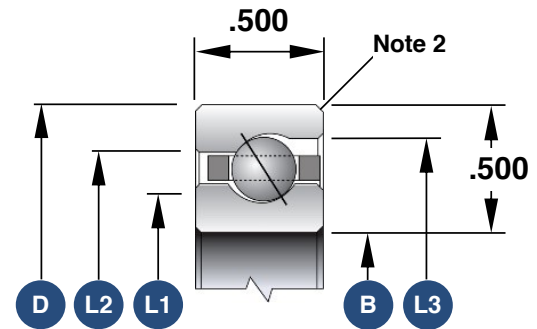

1. Load capacities are not additive
2. The maximum shaft or housing fillet radius that the bearing corners will clear for this series is 0.060"
3. Race Width Tolerance: +0.000 -0.005"

Also Available

Open Radial Contact	SD200CP0
Open 4-Point Contact	SD200XP0
Open Duplexed (Back-to-Back)	SD200BR0
Open Duplexed (Face-to-Face)	SD200FR0