

SILVERTHIN SD200CPO**20 in Open Type C Thin Section Bearing****Specifications**

Bore (B)	20.000 in
Outside Diameter (D)	21.000 in
Width	1/2"
Land Diameter (L ₁)	20.370 in
Land Diameter (L ₂)	20.630 in
Approximate Weight	3.85 lbs
Separator	Brass; snapover separator
Precision Class	ABEC Class 1
Bearing Type	Radial Contact (Type C)
Seals, Shields	None (Open)
Unit System	Inch

Load Capacities

Static Radial Load	14,020 lbf
Dynamic Radial Load	4,165 lbf

Interchange

Silverthin	SD200CPO	Kaydon	KD200CPO	Kaydon	KD200CPO	INA	CSCD200
SKF	FPCD2000	FAG	L10TA2000	NSK	NBC50812	NTN	KRD200
SSB	RD200CPO	RBC	KD200CPO*RBC				

Brass; snapover separator

1/4" balls

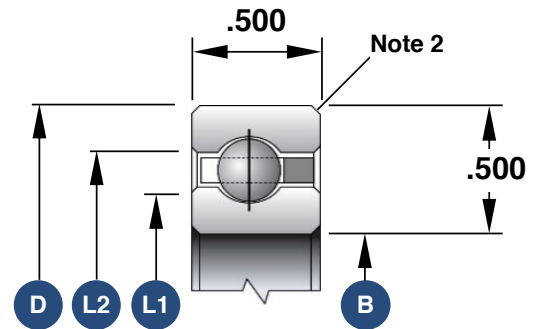

1. Load capacities are not additive
2. The maximum shaft or housing fillet radius that the bearing corners will clear for this series is 0.060"
3. Race Width Tolerance: +0.000 -0.005"

Also Available

Open Angular Contact	SD200ARO
Open 4-Point Contact	SD200XPO
Open Duplexed (Back-to-Back)	SD200BRO
Open Duplexed (Face-to-Face)	SD200FRO