

SILVERTHIN SD200XP0**20 in Open Type X Thin Section Bearing****Specifications**

Bore (B)	20.000 in
Outside Diameter (D)	21.000 in
Width	1/2"
Land Diameter (L ₁)	20.370 in
Land Diameter (L ₂)	20.630 in
Approximate Weight	3.85 lbs
Separator	Brass; snapover separator
Precision Class	ABEC Class 1
Bearing Type	4-Point Contact (Type X)
Seals, Shields	None (Open)
Unit System	Inch

Load Capacities

Static Radial Load	14,020 lbf
Dynamic Radial Load	5,535 lbf
Static Thrust Load	35,060 lbf
Dynamic Thrust Load	9,670 lbf
Static Moment Load	143,700 in-lbs
Dynamic Moment Load	42,560 in-lbs

Interchange

Silverthin	SD200XP0	Kaydon	KD200XP0	Kaydon	KD200XP0	INA	CSXD200
SKF	FPXD2000	FAG	L18TA2000	NSK	NBX50812	NTN	KXD200
SSB	RD200XP0	RBC	KD200XP0*RBC				

Brass; snapover separator

1/4" balls

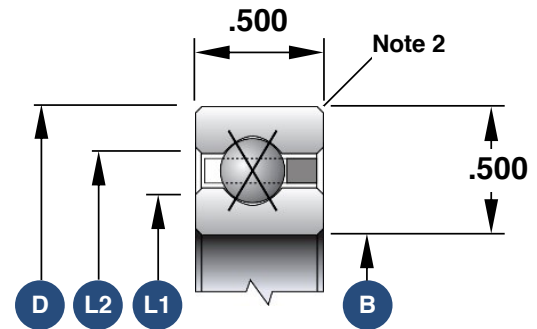

1. Load capacities are not additive
2. The maximum shaft or housing fillet radius that the bearing corners will clear for this series is 0.060"
3. Race Width Tolerance: +0.000 -0.005"

Also Available

Open Angular Contact	SD200ARO
Open Radial Contact	SD200CPO
Open Duplexed (Back-to-Back)	SD200BRO
Open Duplexed (Face-to-Face)	SD200FRO