

SILVERTHIN SD250AR0**25 in Open Type A Thin Section Bearing****Specifications**

Bore (B)	25.000 in
Outside Diameter (D)	26.000 in
Width	1/2"
Land Diameter (L ₁)	25.370 in
Land Diameter (L ₂)	25.630 in
Land Diameter (L ₃)	25.688 in
Approximate Weight	4.79 lbs
Separator	Brass; one piece pocket separator
Precision Class	ABEC Class 1
Bearing Type	Angular Contact (Type A)
Seals, Shields	None (Open)
Unit System	Inch

Load Capacities

Static Radial Load	20,140 lbf
Dynamic Radial Load	4,910 lbf
Static Thrust Load	58,140 lbf
Dynamic Thrust Load	13,540 lbf

Interchange

Silverthin	SD250AR0	Kaydon	KD250AR0
SKF	FPAD2500	FAG	L15TA2500
SSB	RD250AR0	RBC	KD250AR0*RBC

Brass; one piece pocket separator

1/4" balls

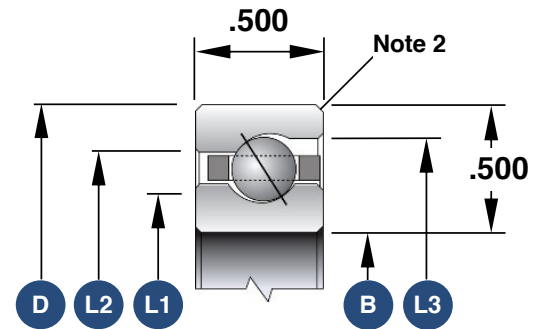

1. Load capacities are not additive
2. The maximum shaft or housing fillet radius that the bearing corners will clear for this series is 0.060"
3. Race Width Tolerance: +0.000 -0.005"

Also Available

Open Radial Contact	SD250CP0
Open 4-Point Contact	SD250XP0
Open Duplexed (Back-to-Back)	SD250BR0
Open Duplexed (Face-to-Face)	SD250FR0