

SILVERTHIN SD250CPO**25 in Open Type C Thin Section Bearing****Specifications**

Bore (B)	25.000 in
Outside Diameter (D)	26.000 in
Width	1/2"
Land Diameter (L ₁)	25.370 in
Land Diameter (L ₂)	25.630 in
Approximate Weight	4.79 lbs
Separator	Brass; snapover separator
Precision Class	ABEC Class 1
Bearing Type	Radial Contact (Type C)
Seals, Shields	None (Open)
Unit System	Inch

Load Capacities

Static Radial Load	17,440 lbf
Dynamic Radial Load	4,690 lbf

Interchange

Silverthin	SD250CPO	Kaydon	KD250CPO	Kaydon	KD250CPO	INA	CSCD250
SKF	FPCD2500	FAG	L10TA2500	NSK	NBC63512	NTN	KRD250
SSB	RD250CPO	RBC	KD250CPO*RBC				

Brass; snapover separator

1/4" balls

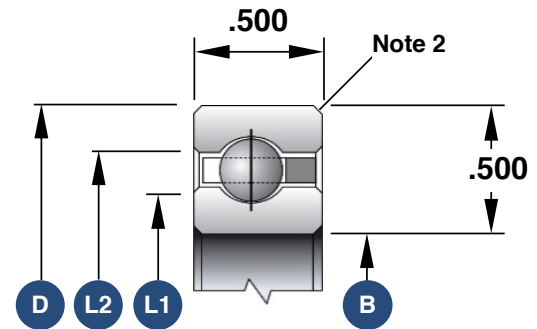

1. Load capacities are not additive
2. The maximum shaft or housing fillet radius that the bearing corners will clear for this series is 0.060"
3. Race Width Tolerance: +0.000 -0.005"

Also Available

Open Angular Contact	SD250ARO
Open 4-Point Contact	SD250XPO
Open Duplexed (Back-to-Back)	SD250BR0
Open Duplexed (Face-to-Face)	SD250FR0