

SILVERTHIN SD250XP0**25 in Open Type X Thin Section Bearing****Specifications**

Bore (B)	25.000 in
Outside Diameter (D)	26.000 in
Width	1/2"
Land Diameter (L ₁)	25.370 in
Land Diameter (L ₂)	25.630 in
Approximate Weight	4.79 lbs
Separator	Brass; snapover separator
Precision Class	ABEC Class 1
Bearing Type	4-Point Contact (Type X)
Seals, Shields	None (Open)
Unit System	Inch

Load Capacities

Static Radial Load	17,440 lbf
Dynamic Radial Load	6,235 lbf
Static Thrust Load	43,610 lbf
Dynamic Thrust Load	11,180 lbf
Static Moment Load	222,400 in-lbs
Dynamic Moment Load	59,650 in-lbs

Interchange

Silverthin	SD250XP0	Kaydon	KD250XP0	Kaydon	KD250XP0	INA	CSXD250
SKF	FPXD2500	FAG	L18TA2500	NSK	NBX63512	NTN	KXD250
SSB	RD250XP0	RBC	KD250XP0*RBC				

Brass; snapover separator

1/4" balls

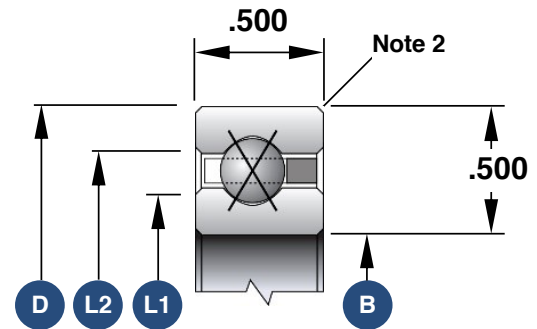

1. Load capacities are not additive
2. The maximum shaft or housing fillet radius that the bearing corners will clear for this series is 0.060"
3. Race Width Tolerance: +0.000 -0.005"

Also Available

Open Angular Contact	SD250ARO
Open Radial Contact	SD250CPO
Open Duplexed (Back-to-Back)	SD250BR0
Open Duplexed (Face-to-Face)	SD250FR0