

SILVERTHIN SD300ARO**30 in Open Type A Thin Section Bearing****Specifications**

Bore (B)	30.000 in
Outside Diameter (D)	31.000 in
Width	1/2"
Land Diameter (L ₁)	30.370 in
Land Diameter (L ₂)	30.630 in
Land Diameter (L ₃)	30.672 in
Approximate Weight	5.73 lbs
Separator	Brass; one piece pocket separator
Precision Class	ABEC Class 1
Bearing Type	Angular Contact (Type A)
Seals, Shields	None (Open)
Unit System	Inch

Load Capacities

Static Radial Load	24,090 lbf
Dynamic Radial Load	5,395 lbf
Static Thrust Load	69,540 lbf
Dynamic Thrust Load	15,260 lbf

Interchange

Silverthin	SD300ARO	Kaydon	KD300ARO
SKF	FPAD3000	FAG	L15TA3000
SSB	RD300ARO	RBC	KD300ARO*RBC

Brass; one piece pocket separator

1/4" balls

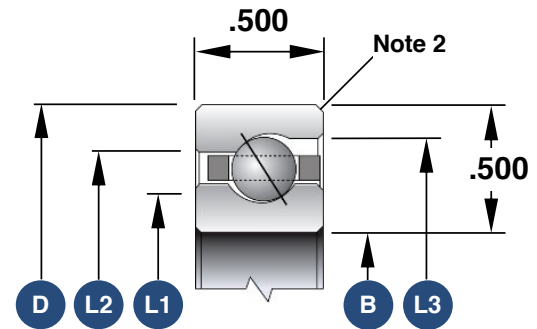

1. Load capacities are not additive
2. The maximum shaft or housing fillet radius that the bearing corners will clear for this series is 0.060"
3. Race Width Tolerance: +0.000 -0.005"

Also Available

Open Radial Contact	SD300CP0
Open 4-Point Contact	SD300XP0
Open Duplexed (Back-to-Back)	SD300BR0
Open Duplexed (Face-to-Face)	SD300FR0