

SILVERTHIN SD300CPO**30 in Open Type C Thin Section Bearing****Specifications**

Bore (B)	30.000 in
Outside Diameter (D)	31.000 in
Width	1/2"
Land Diameter (L ₁)	30.370 in
Land Diameter (L ₂)	30.630 in
Approximate Weight	5.73 lbs
Separator	Brass; snapover separator
Precision Class	ABEC Class 1
Bearing Type	Radial Contact (Type C)
Seals, Shields	None (Open)
Unit System	Inch

Load Capacities

Static Radial Load	20,860 lbf
Dynamic Radial Load	5,155 lbf

Interchange

Silverthin	SD300CPO	Kaydon	KD300CPO	Kaydon	KD300CPO	INA	CSCD300
SKF	FPCD3000	FAG	L10TA3000	NSK	NBC76212	NTN	KRD300
SSB	RD300CPO	RBC	KD300CPO*RBC				

Brass; snapover separator

1/4" balls

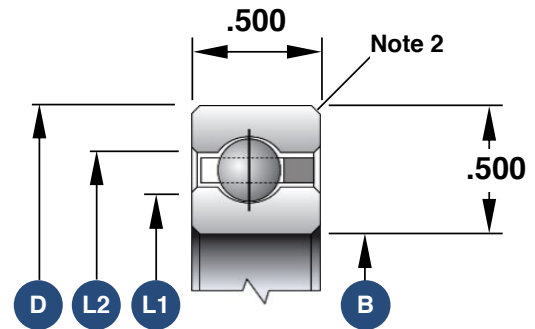

1. Load capacities are not additive
2. The maximum shaft or housing fillet radius that the bearing corners will clear for this series is 0.060"
3. Race Width Tolerance: +0.000 -0.005"

Also Available

Open Angular Contact	SD300ARO
Open 4-Point Contact	SD300XPO
Open Duplexed (Back-to-Back)	SD300BRO
Open Duplexed (Face-to-Face)	SD300FRO