

SILVERTHIN SD300XPO**30 in Open Type X Thin Section Bearing****Specifications**

Bore (B)	30.000 in
Outside Diameter (D)	31.000 in
Width	1/2"
Land Diameter (L ₁)	30.370 in
Land Diameter (L ₂)	30.630 in
Approximate Weight	5.73 lbs
Separator	Brass; snapover separator
Precision Class	ABEC Class 1
Bearing Type	4-Point Contact (Type X)
Seals, Shields	None (Open)
Unit System	Inch

Load Capacities

Static Radial Load	20,860 lbf
Dynamic Radial Load	6,855 lbf
Static Thrust Load	52,160 lbf
Dynamic Thrust Load	12,600 lbf
Static Moment Load	318,100 in-lbs
Dynamic Moment Load	78,445 in-lbs

Interchange

Silverthin	SD300XPO	Kaydon	KD300XPO	Kaydon	KD300XPO	INA	CSXD300
SKF	FPXD3000	FAG	L18TA3000	NSK	NBX76212	NTN	KXD300
SSB	RD300XPO	RBC	KD300XPO*RBC				

Brass; snapover separator

1/4" balls

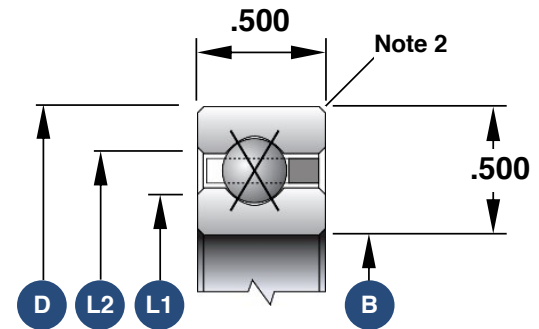

1. Load capacities are not additive
2. The maximum shaft or housing fillet radius that the bearing corners will clear for this series is 0.060"
3. Race Width Tolerance: +0.000 -0.005"

Also Available

Open Angular Contact	SD300ARO
Open Radial Contact	SD300CPO
Open Duplexed (Back-to-Back)	SD300BRO
Open Duplexed (Face-to-Face)	SD300FRO