

SILVERTHIN SF100CPO**10 in Open Type C Thin Section Bearing****Specifications**

| | |
|---------------------------------|---------------------------|
| Bore (B) | 10.000 in |
| Outside Diameter (D) | 11.500 in |
| Width | 3/4" |
| Land Diameter (L ₁) | 10.555 in |
| Land Diameter (L ₂) | 10.945 in |
| Approximate Weight | 4.30 lbs |
| Separator | Brass; snapover separator |
| Precision Class | ABEC Class 1 |
| Bearing Type | Radial Contact (Type C) |
| Seals, Shields | None (Open) |
| Unit System | Inch |

Load Capacities

| | |
|---------------------|------------|
| Static Radial Load | 12,130 lbf |
| Dynamic Radial Load | 5,550 lbf |

Interchange

| | | | | | | | |
|------------|----------|--------|--------------|--------|----------|-----|---------|
| Silverthin | SF100CPO | Kaydon | KF100CPO | Kaydon | KF100CPO | INA | CSCF100 |
| SKF | FPCF1000 | FAG | L10VA1000 | NSK | NBC25419 | NTN | KRF100 |
| SSB | RF100CPO | RBC | KF100CPO*RBC | | | | |

Brass; snapover separator

3/8" balls

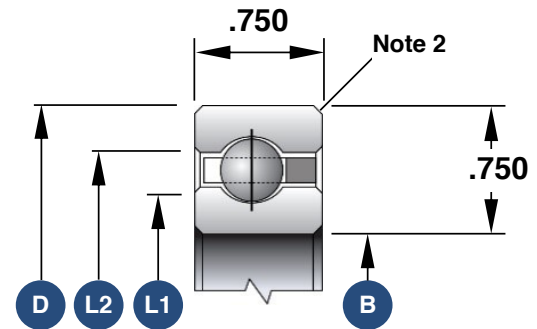

1. Load capacities are not additive
2. The maximum shaft or housing fillet radius that the bearing corners will clear for this series is 0.080"
3. Race Width Tolerance: +0.000 -0.005"

Also Available

| | |
|------------------------------|----------|
| Open Angular Contact | SF100ARO |
| Open 4-Point Contact | SF100XPO |
| Open Duplexed (Back-to-Back) | SF100BRO |
| Open Duplexed (Face-to-Face) | SF100FRO |