

SILVERTHIN SF250AR0**25 in Open Type A Thin Section Bearing****Specifications**

Bore (B)	25.000 in
Outside Diameter (D)	26.500 in
Width	3/4"
Land Diameter (L ₁)	25.555 in
Land Diameter (L ₂)	25.945 in
Land Diameter (L ₃)	26.085 in
Approximate Weight	10.90 lbs
Separator	Brass; one piece pocket separator
Precision Class	ABEC Class 1
Bearing Type	Angular Contact (Type A)
Seals, Shields	None (Open)
Unit System	Inch

Load Capacities

Static Radial Load	34,700 lbf
Dynamic Radial Load	9,585 lbf
Static Thrust Load	100,200 lbf
Dynamic Thrust Load	26,100 lbf

Interchange

Silverthin	SF250AR0	Kaydon	KF250AR0
SKF	FPAF2500	FAG	L15VA2500
SSB	RF250AR0	RBC	KF250AR0*RBC

Brass; one piece pocket separator

3/8" balls

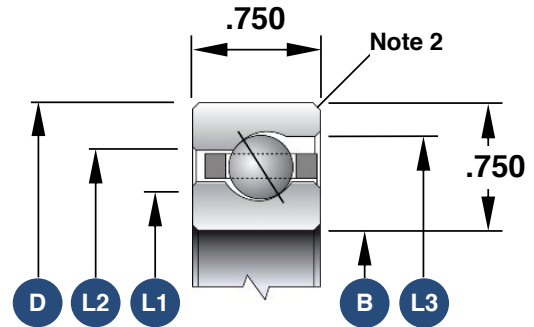

1. Load capacities are not additive
2. The maximum shaft or housing fillet radius that the bearing corners will clear for this series is 0.080"
3. Race Width Tolerance: +0.000 -0.005"

Also Available

Open Radial Contact	SF250CP0
Open 4-Point Contact	SF250XP0
Open Duplexed (Back-to-Back)	SF250BR0
Open Duplexed (Face-to-Face)	SF250FR0