

SILVERTHIN SG040AR0**4 in Open Type A Thin Section Bearing****Specifications**

Bore (B)	4.000 in
Outside Diameter (D)	6.000 in
Width	1"
Land Diameter (L ₁)	4.742 in
Land Diameter (L ₂)	5.258 in
Land Diameter (L ₃)	5.491 in
Approximate Weight	3.60 lbs
Separator	Brass; one piece pocket separator
Precision Class	ABEC Class 1
Bearing Type	Angular Contact (Type A)
Seals, Shields	None (Open)
Unit System	Inch

Load Capacities

Static Radial Load	9,480 lbf
Dynamic Radial Load	6,280 lbf
Static Thrust Load	27,360 lbf
Dynamic Thrust Load	13,630 lbf

Interchange

Silverthin	SG040AR0	Kaydon	KG040AR0
SKF	FPAG400	FAG	L15WA300
SSB	RG040AR0	RBC	KG040AR0*RBC

Brass; one piece pocket separator

1/2" balls

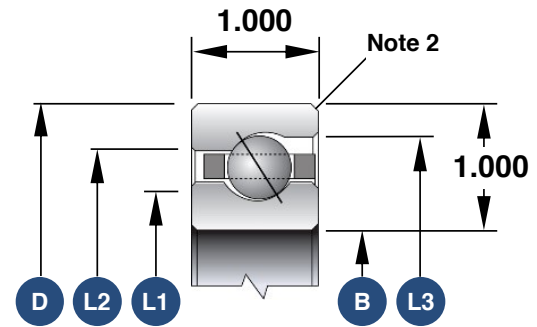

1. Load capacities are not additive
2. The maximum shaft or housing fillet radius that the bearing corners will clear for this series is 0.080"
3. Race Width Tolerance: +0.000 -0.005"

Also Available

Open Radial Contact	SG040CP0
Open 4-Point Contact	SG040XP0
Open Duplexed (Back-to-Back)	SG040BR0
Open Duplexed (Face-to-Face)	SG040FR0