

SILVERTHIN SG040XPO**4 in Open Type X Thin Section Bearing****Specifications**

Bore (B)	4.000 in
Outside Diameter (D)	6.000 in
Width	1"
Land Diameter (L ₁)	4.742 in
Land Diameter (L ₂)	5.258 in
Approximate Weight	3.60 lbs
Separator	Brass; snapover separator
Precision Class	ABEC Class 1
Bearing Type	4-Point Contact (Type X)
Seals, Shields	None (Open)
Unit System	Inch

Load Capacities

Static Radial Load	8,210 lbf
Dynamic Radial Load	7,980 lbf
Static Thrust Load	20,520 lbf
Dynamic Thrust Load	11,260 lbf
Static Moment Load	20,520 in-lbs
Dynamic Moment Load	14,965 in-lbs

Interchange

Silverthin	SG040XPO	Kaydon	KG040XPO	Kaydon	KG040XPO	INA	CSXG040
SKF	FPXG400	FAG	L18WA300	NSK	NBX10125	NTN	KXG040
SSB	RG040XPO	RBC	KG040XPO*RBC				

Brass; snapover separator

1/2" balls

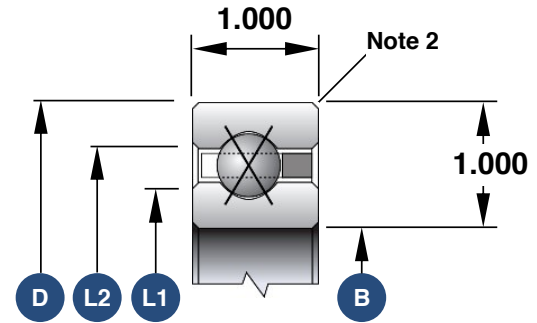

1. Load capacities are not additive
2. The maximum shaft or housing fillet radius that the bearing corners will clear for this series is 0.080"
3. Race Width Tolerance: +0.000 -0.005"

Also Available

Open Angular Contact	SG040AR0
Open Radial Contact	SG040CP0
Open Duplexed (Back-to-Back)	SG040BR0
Open Duplexed (Face-to-Face)	SG040FR0