

SILVERTHIN SG042AR0**4.25 in Open Type A Thin Section Bearing****Specifications**

Bore (B)	4.250 in
Outside Diameter (D)	6.250 in
Width	1"
Land Diameter (L ₁)	4.992 in
Land Diameter (L ₂)	5.508 in
Land Diameter (L ₃)	5.741 in
Approximate Weight	3.80 lbs
Separator	Brass; one piece pocket separator
Precision Class	ABEC Class 1
Bearing Type	Angular Contact (Type A)
Seals, Shields	None (Open)
Unit System	Inch

Load Capacities

Static Radial Load	9,950 lbf
Dynamic Radial Load	6,440 lbf
Static Thrust Load	28,730 lbf
Dynamic Thrust Load	14,090 lbf

Interchange

Silverthin	SG042AR0	Kaydon	KG042AR0
SKF	FPAG404	FAG	L15WA308
SSB	RG042AR0	RBC	KG042AR0*RBC

Brass; one piece pocket separator

1/2" balls

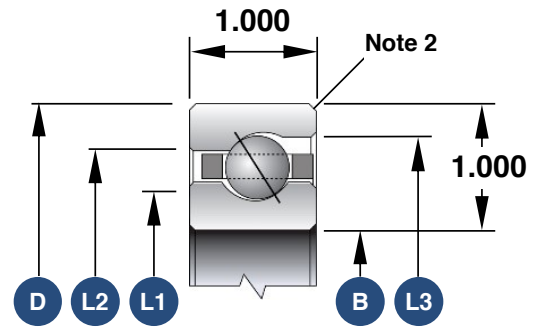

1. Load capacities are not additive
2. The maximum shaft or housing fillet radius that the bearing corners will clear for this series is 0.080"
3. Race Width Tolerance: +0.000 -0.005"

Also Available

Open Radial Contact	SG042CP0
Open 4-Point Contact	SG042XP0
Open Duplexed (Back-to-Back)	SG042BR0
Open Duplexed (Face-to-Face)	SG042FR0