

SILVERTHIN SG042CP0**4.25 in Open Type C Thin Section Bearing****Specifications**

Bore (B)	4.250 in
Outside Diameter (D)	6.250 in
Width	1"
Land Diameter (L ₁)	4.992 in
Land Diameter (L ₂)	5.508 in
Approximate Weight	3.80 lbs
Separator	Brass; snapover separator
Precision Class	ABEC Class 1
Bearing Type	Radial Contact (Type C)
Seals, Shields	None (Open)
Unit System	Inch

Load Capacities

Static Radial Load	8,210 lbf
Dynamic Radial Load	6,060 lbf

Interchange

Silverthin	SG042CP0	Kaydon	KG042CP0	Kaydon	KG042CP0	INA	CSCG042
SKF	FPCG404	FAG	L10WA308	NSK	NBC10725	NTN	KRG042
SSB	RG042CP0	RBC	KG042CP0*RBC				

Brass; snapover separator

1/2" balls

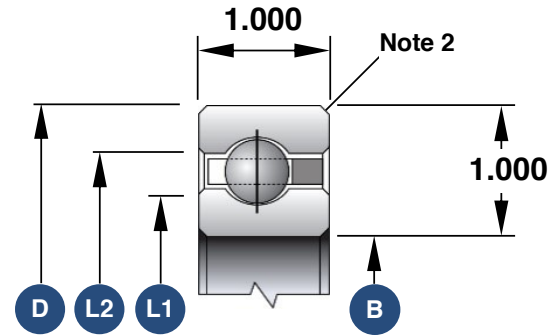

1. Load capacities are not additive
2. The maximum shaft or housing fillet radius that the bearing corners will clear for this series is 0.080"
3. Race Width Tolerance: +0.000 -0.005"

Also Available

Open Angular Contact	SG042AR0
Open 4-Point Contact	SG042XP0
Open Duplexed (Back-to-Back)	SG042BR0
Open Duplexed (Face-to-Face)	SG042FR0