

SILVERTHIN SG042XP0**4.25 in Open Type X Thin Section Bearing****Specifications**

Bore (B)	4.250 in
Outside Diameter (D)	6.250 in
Width	1"
Land Diameter (L ₁)	4.992 in
Land Diameter (L ₂)	5.508 in
Approximate Weight	3.80 lbs
Separator	Brass; snapover separator
Precision Class	ABEC Class 1
Bearing Type	4-Point Contact (Type X)
Seals, Shields	None (Open)
Unit System	Inch

Load Capacities

Static Radial Load	8,210 lbf
Dynamic Radial Load	7,915 lbf
Static Thrust Load	20,520 lbf
Dynamic Thrust Load	11,260 lbf
Static Moment Load	21,550 in-lbs
Dynamic Moment Load	15,590 in-lbs

Interchange

Silverthin	SG042XP0	Kaydon	KG042XP0	Kaydon	KG042XP0	INA	CSXG042
SKF	FPXG404	FAG	L18WA308	NSK	NBX10725	NTN	KXG042
SSB	RG042XP0	RBC	KG042XP0*RBC				

Brass; snapover separator

1/2" balls

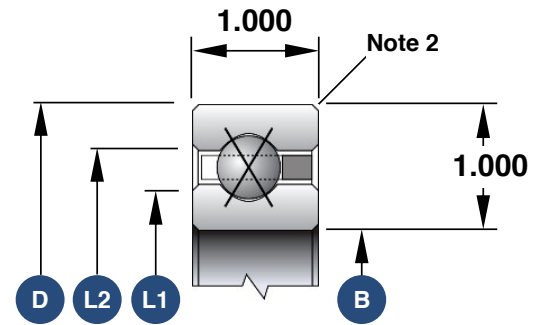

1. Load capacities are not additive
2. The maximum shaft or housing fillet radius that the bearing corners will clear for this series is 0.080"
3. Race Width Tolerance: +0.000 -0.005"

Also Available

Open Angular Contact	SG042AR0
Open Radial Contact	SG042CP0
Open Duplexed (Back-to-Back)	SG042BR0
Open Duplexed (Face-to-Face)	SG042FR0