

SILVERTHIN SG045ARO**4.5 in Open Type A Thin Section Bearing****Specifications**

Bore (B)	4.500 in
Outside Diameter (D)	6.500 in
Width	1"
Land Diameter (L ₁)	5.242 in
Land Diameter (L ₂)	5.758 in
Land Diameter (L ₃)	5.989 in
Approximate Weight	4.00 lbs
Separator	Brass; one piece pocket separator
Precision Class	ABEC Class 1
Bearing Type	Angular Contact (Type A)
Seals, Shields	None (Open)
Unit System	Inch

Load Capacities

Static Radial Load	10,430 lbf
Dynamic Radial Load	6,560 lbf
Static Thrust Load	30,100 lbf
Dynamic Thrust Load	14,530 lbf

Interchange

Silverthin	SG045ARO	Kaydon	KG045ARO
SKF	FPAG408	FAG	L15WA400
SSB	RG045ARO	RBC	KG045ARO*RBC

Brass; one piece pocket separator

1/2" balls

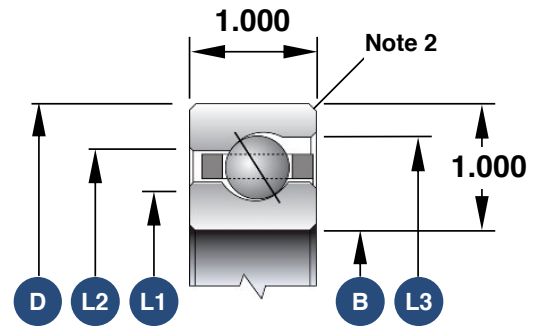

1. Load capacities are not additive
2. The maximum shaft or housing fillet radius that the bearing corners will clear for this series is 0.080"
3. Race Width Tolerance: +0.000 -0.005"

Also Available

Open Radial Contact	SG045CP0
Open 4-Point Contact	SG045XP0
Open Duplexed (Back-to-Back)	SG045BR0
Open Duplexed (Face-to-Face)	SG045FR0